

New Amsterdam Courthouse

Location

Amsterdam,
The Netherlands

Client

Rijksvastgoedbedrijf

Initiated

2014

Completion

2020

Size

47.257 sqm

Project Team

Michael Baas, Beatrice Bagnara, Sjoerd Boomars, Koen Bosman, Dennis Bruijn, Sebastiaan Buitenhuis, Robin Cals, Marten Dashorst, Sebastian van Damme, Luuk Dietz, Cecilia Dobos, Paolo Faleschini, Raluca Firicel, Michael Geensen, Lisa Goes, Narine Gyulkhasyan, Thomas Hayat, Marlon Jonkers, Lianne Klitsie, Jasmijn Kok, Moritz Kuhl, Marco Lanna, Anthony Laurijsen, Yinghao Lin, Johandri Martina, Marija Mateljan, Julian O'Neale, Laura Ospina, Kevin Park, Ana Rivero Esteban, Martijn Schuil, Claudio Zampaglione



The New Amsterdam Courthouse is located at the intersection of the Zuidas and Parnassusweg. The open structure of the architecture offers both employees and visitors views over the city, and passers-by the opportunity to engage with the building. The courthouse building is exemplary in its efficiency, like the organization itself, and is part of the daily life surrounding it. Natural design consequences of this are the big windows at the ground floor as well as the entrance courtyard for public use. The city's streets merge with the layout of the building. The forecourt, the central hall and its foyers, and the waiting areas for visitors are an extension of urban space. Just off the central hall, the building has two independent structures with 50 courtrooms and council chambers, while the large ground-floor courtroom has been designed with a direct access route. The building has several green spaces: an enclosed garden, vertical gardens, a sunken garden and large terrace.

New Amsterdam Courthouse

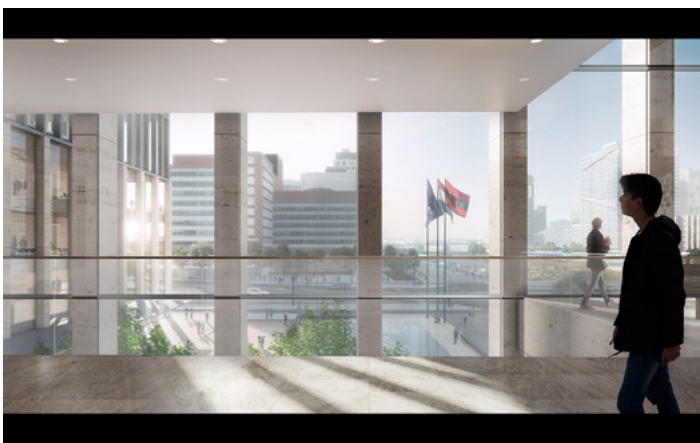
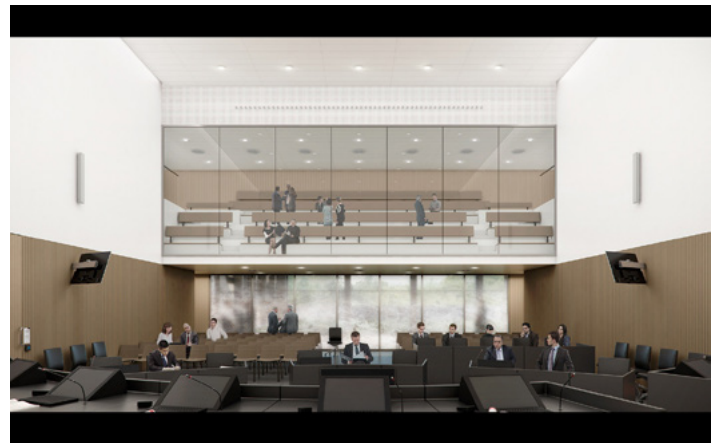

New Amsterdam Courthouse

